

PALMYRA AREA RECREATION AND PARKS COMMISSION (PARPC)

Executive Summary

**Ridge Road Project Update
June 2010**

Submitted by: Tina Manoogian-King
Recreation Director

Project History:

In 2008, The Hershey Company donated 70.91 acres of land, located along Ridge Road, to the Palmyra Area School District for recreational purposes. The Palmyra Area Recreation and Parks Commission (PARPC) in partnership with PASD developed an agreement related to the use of this property. As a result, PARPC developed a master plan and operating program so as to maximize the use of this parcel while addressing the needs of the communities it will serve. It is important to note that the 3 municipalities to be served by this facility include the Borough of Palmyra, North Londonderry and South Londonderry Townships. The Palmyra Area School District serves the educational needs for children residing in these three communities.

Prior to a master plan being developed for the Ridge Road property, a Steering Committee was formed and served as the catalyst to secure input from the various agencies and groups that would be using this facility. Input was provided by Boy's Lacrosse; Palmyra Civic Baseball; Campbelltown Youth Soccer Club; Palmyra Area Girl's Softball Association; Men's Fast Pitch Softball; Women's Fast Pitch; Palmyra Girl's Softball Association; Palmyra Church Softball; Palmyra Midget Football Association; PARPC Recreational Youth Soccer; Girl's Field Hockey, Friends of the PARPC and Palmyra Area Recreation and Parks Commission. A list of infrastructure improvements needed and recreational facilities desired were prioritized. Evans Engineering was hired by PARPC to draft a design for the Ridge Road property based upon input received from the various community groups listed above.

In addition to creating the park's interior design, Evans Engineering also prepared a cost estimate based upon a phase approach. Four potential phases were identified with safe motor vehicle access to and from the site being the first priority. The estimated cost to develop this site is \$9 million dollars and is dependent upon availability of funding. No timetable for development was adopted and the project will be completed in phases as monies become available. Partnerships with various local organizations will permit specific facilities within each phase to be undertaken so long as the funding is in place. PARPC has taken the position that the park should be developed without the use of incremental tax funding. Maintenance costs associated with this property are to be covered by park rental fees so as to not cause a new unfunded burden for the three municipalities to be served.

Other sources of funding to develop this site will come from state, federal and foundation grants as well as contributions from local corporations, area businesses and private contributions. In addition, PARPC will partner with youth and adult sports groups, special interest/focus groups and PASD so that no one entity is saddled with the costs to build or maintain this site. Requests from special interest groups include a walking trail system, a chip and putt golf course area, a dog park, community vegetable gardens and a skateboard park. PARPC will develop rules and regulations for use of the park as well as park rental applications. Facility scheduling will be handled by PARPC staff. Maintenance is currently being performed by the PASD and a local farmer that mows the property. Once the site is developed, user fees will fund on-going maintenance of the property. It is anticipated that this maintenance work could be contracted out to the private sector with funding coming from the park rentals.

Steering Committee Members

Phil Rothermel - PARPC and South Londonderry Twp. Supervisor
Keith Costello - PARPC and Palmyra Borough
Dr. Larry Schmidt – PASD - Superintendent
Mark Panassow - PARPC
Brian Weidler – PASD – Athletic Director
Darcy Brenner-Smith – PASD – Business Manager
Mike Bratton – PARPC
Steve Johnson
Ann Donnelly – Friends of PARPC
Lois Fanus – Shadow Stone Neighborhood
Dean Fernsler – Lebanon County Planning Dept. and resident
Barry Riegle – PARPC and North Londonderry Twp
George Downey – PASD Board President
Gerald Wimmer – PARPC and PASD
Craig Cope- PASD- Maintenance Director

Community Group's Input

Boy's Lacrosse – George Downey (President)
Palmyra Civic Baseball – Tim Yingst (President)
Campbelltown Youth Soccer Club – Tom Shoemaker
Palmyra Area Girl's Softball Association – Bob and Kathy Wicker
Men's Fast Pitch Softball – Bob Wicker
Women's Fast Pitch – Kathy Wicker
PGSA – Jennifer Porter
Palmyra Church Softball – Kevin Keller
Palmyra Midget Football Association – Doug Lewis
PARPC Recreational Youth Soccer – Mike Dewalt
Girl's Field Hockey – Kent Harshman

General Public Input

Pat Hennessy – Dog Park
Tom Mauer – Community Gardens
Nicole Rudigeair – Dog Park
Alex Rudigeair – Skateboard Park
Scott Steele – Roller Hockey

Palmyra Area Recreation and Parks Commission
Ridge Road Plan Summary (revised)
March 30, 2010

- (3) Multi-purpose athletic fields 180' x 320' (field length should be increased to 360')
- (3) Multi-purpose athletic fields 180' x 360'
- (1) Softball field 315' to outfield fence with 60'-65' bases with skinned infield
- (2) Softball fields 360' to outfield fence with 60'-65' bases with skinned infield
- (1) Baseball field 300' - 380' outfield fence with 90' bases with grass infield
- (1) Baseball field 200' to outfield fence with 60' bases with grass infield
- (4) Concession stands with restrooms and storage (concession areas should be reduced in quantity, placed more centrally, and enlarged to accommodate a combined picnic area)
- (1) Picnic pavilion
- (3) Volleyball courts (sand)
- (4) Bocce courts
- (2) Basketball courts
- (2) Tennis courts
- (2) Horseshoe pits
- (2) Tot-lots
- (1) Dog Park (Met with Insurance carrier-so long as we abide by their rules-no increase in insurance is expected.)
- (1) Skateboard Park (Met with Insurance carrier and costs will increase to accommodate this type of activity – additional cost \$2500-\$4,000 per year)
- (1) Golf area (chip and putt)
- (1) Maintenance Shed (Shed needs to be increased in size to accommodate the equipment needed to properly maintain this complex)
- (416) Parking spaces

12,800 linear feet of bike trails at a width of 8' (approximately)

4,000 linear feet of roadway at a width of 24' (approximately)

Note:

Facility amenities not listed on the plans: bleachers for some of the fields, player benches, dug-outs, lighting (courts and fields), water fountains, bike racks, irrigation systems and park benches.

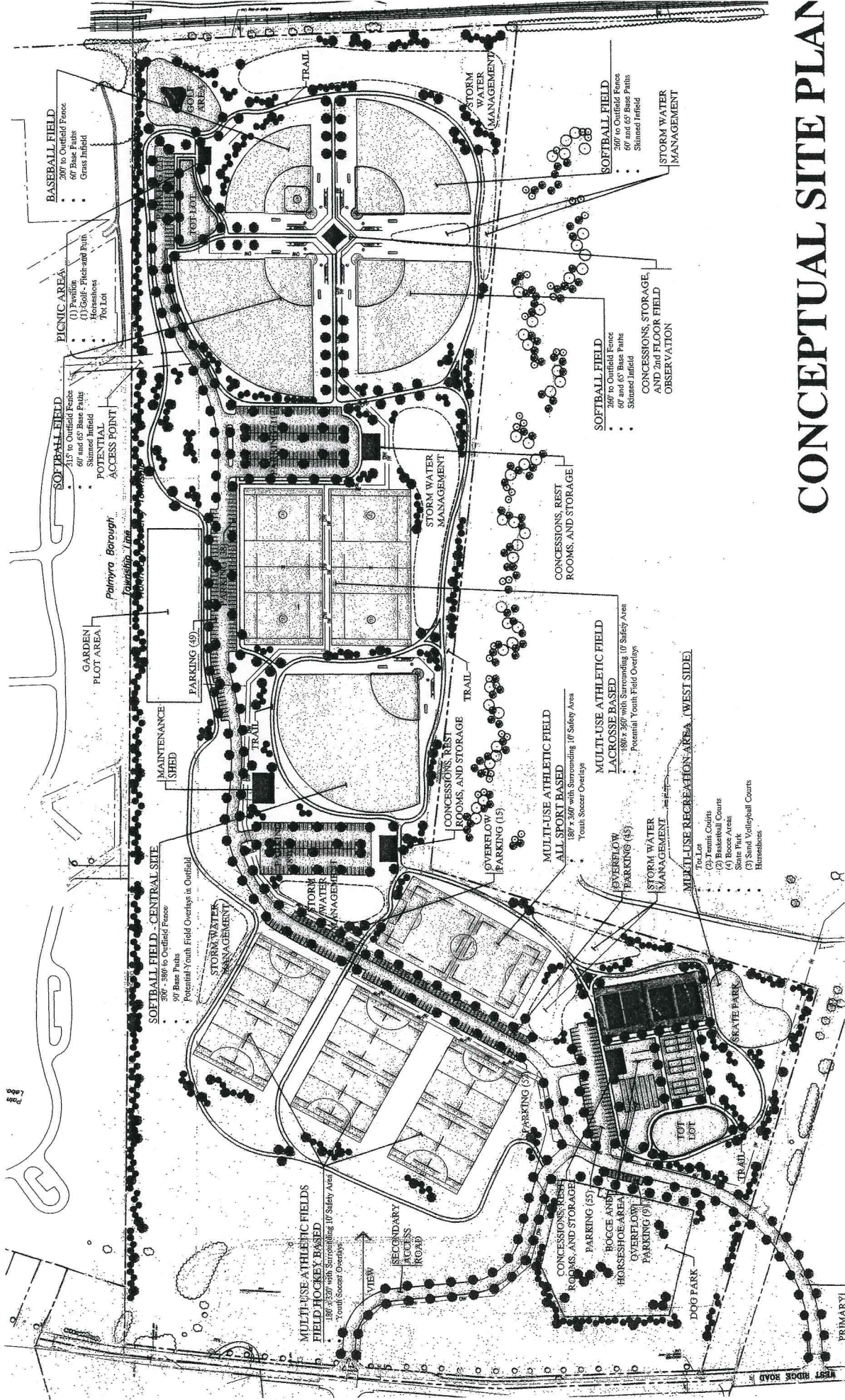

CONCEPTUAL SITE PLAN

RIDGE ROAD RECREATION FIELDS

NORTH LONDONDERRY TOWNSHIP, PENNSYLVANIA
 PALMYRA AREA RECREATION DEPARTMENT
 EVANS ENGINEERING, INCORPORATED ARCHITERRA, PC

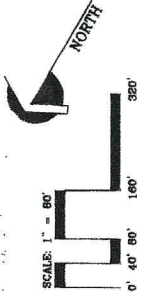

30 MARCH 2010